

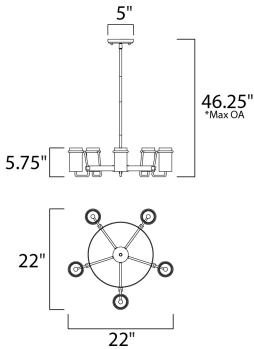

PRODUCT DESCRIPTION

Satin White glass cylinders are cradled in castings of Polished Chrome to create this crisp and clean contemporary design. Each fixture is supplied with xenon lamps for good illumination. High style at an affordable price.



*max overall height

MEASUREMENTS

- DIMENSION : 22" L x 22" W x 5.75" H
- MAX OAH : 46.25" OAH
- CANOPY : 5" W x 0.75" H x 5" L
- HANGING WEIGHT : 7.26 lb
- WIRE LENGTH : 120"

LAMPING

- INPUT VOLTAGE : 120V
- LUMENS : 2,450 Rated
- BULB : 40W Xenon G9 , 200W Total
- BULB INCLUDED : (Included)
- DIMMABLE : Yes

FINISHES OPTION

- Polished Chrome (PC)

GLASS

Satin White SW

MATERIAL

Steel, Glass

RATINGS

cETLus
Dry Location



ADDITIONAL

ADJUSTABLE
SLOPE:
RATED LIFE 2000 Hours
OPERATING TEMPERATURE:
-20°C (-4°F), 40°C (104°F)

Always consult a qualified electrician before installing any lighting product.

STUDIO•M

Modifications or Customizations: Please email contract@studiomlighting.com
Sample Request: Please email order@studiomlighting.com with subject line
"Sample Order_ [Project Name] / [Specifier/Designer]"
All samples are subject to Studio M approval and must show proof of project and/or explanation.

Job Name:	Job Type:
Quantity:	Comments: