

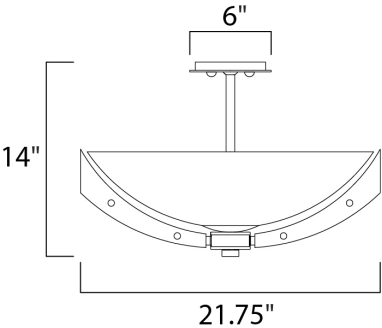

PRODUCT DESCRIPTION

A modern classic created using mixed medium in complimentary finishes that come together to compose a beautiful art form. Available in your choice of Wenge wood with Black and Polished Nickel accents or Antique Pecan wood with Bronze and Satin Brass. Tall Clear glass cylinders with a frosted band complement the scale of the design.



MEASUREMENTS

DIMENSION : 21.75" L x 21.75" W x 14" H
MAX OAH : 56" OAH
CANOPY : 6" W x 0.75" H x 6" L
HANGING WEIGHT : 17.1 lb
WIRE LENGTH : 120"

LAMPING

INPUT VOLTAGE : 120V
LUMENS : 1,960 Rated
BULB : 40W Xenon G9 , 160W Total
BULB INCLUDED : (Included)
DIMMABLE : Yes

FINISHES OPTION

- Black / Wenge (BKWE)
- Bronze / Antique Pecan (BZAP)

GLASS

Clear CL

MATERIAL

Steel, Wood, Glass

RATINGS

cETLus
Dry Location



ADDITIONAL

SLOPE:
RATED LIFE 2000 Hours
OPERATING TEMPERATURE:
-20°C (-4°F), 40°C (104°F)

Always consult a qualified electrician before installing any lighting product.

STUDIO•M

Modifications or Customizations: Please email contract@studiomlighting.com
Sample Request: Please email order@studiomlighting.com with subject line
"Sample Order_ [Project Name] / [Specifier/Designer]"
All samples are subject to Studio M approval and must show proof of project and/or explanation.

Job Name:	Job Type:
Quantity:	Comments