

PRODUCT DESCRIPTION

Frames of wood finished in Barn Wood and cradled by Black metal brackets were used to create this beautiful rustic design. The Black mesh screen is accented with a band of mica and Antique Brass sockets to deliver rustic charm with all the right fixings.

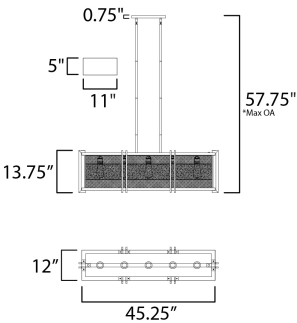

*max overall height

MEASUREMENTS

DIMENSION : 45.25" L x 12" W x 13.75" H
MAX OAH : 57.75" OAH
CANOPY : 5" W x 0.75" H x 11" L
HANGING WEIGHT : 25.08 lb

LAMPING

INPUT VOLTAGE : 120V
BULB : 60W Incandescent E26 Medium , 300W Total
BULB INCLUDED : (Not Included)
DIMMABLE :

FINISHES OPTION

Black / Barn Wood / Antique Brass (BKBWAB)

MATERIAL

Steel, Wood, Mica

RATINGS

cULus
Dry Location



ADDITIONAL

ADJUSTABLE
SLOPE: 90
OPERATING TEMPERATURE:
-20°C (-4°F), 40°C (104°F)

Always consult a qualified electrician before installing any lighting product.

STUDIO•M

Modifications or Customizations: Please email contract@studiomlighting.com
Sample Request: Please email order@studiomlighting.com with subject line
"Sample Order_ [Project Name] / [Specifier/Designer]"
All samples are subject to Studio M approval and must show proof of project and/or explanation.

Job Name:	Job Type:
Quantity:	Comments