

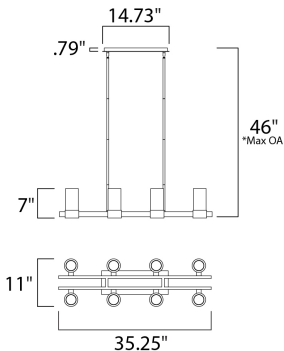

PRODUCT DESCRIPTION

The Silo collection makes artful use of thin-profile rectangular tubing with a mirror-like Polished Chrome finish for a clean, contemporary look. A subtle Frost on the underside of the two cylindrical glass shades adds softness to the sleek lines, while the bright Xenon lamps are cleverly concealed in the cast metal ring allowing ample light to cast both upwards and downwards without glare.



\*max overall height

MEASUREMENTS

DIMENSION : 35.25" L x 11" W x 7" H  
MAX OAH : 46" OAH  
CANOPY : 4.33" W x 0.79" H x 14.73" L  
HANGING WEIGHT : 17.6 lb

LAMPING

INPUT VOLTAGE : 120V  
LUMENS : 3,600 Rated (3,200 Del.)  
BULB : 40W Xenon G9 , 320W Total  
BULB INCLUDED : (Included)  
DIMMABLE : Yes  
COLOR\_TEMP : 2900K

FINISHES OPTION

 Polished Chrome (PC)

GLASS

Clear and Frosted CLFT

MATERIAL

Metal, Glass

RATINGS

cETLus  
Dry Location



ADDITIONAL

ADJUSTABLE  
SLOPE: 120  
RATED LIFE 2000 Hours  
OPERATING TEMPERATURE:  
-20°C (-4°F), 40°C (104°F)

Always consult a qualified electrician before installing any lighting product.

STUDIO•M

Modifications or Customizations: Please email [contract@studiomlighting.com](mailto:contract@studiomlighting.com)  
Sample Request: Please email [order@studiomlighting.com](mailto:order@studiomlighting.com) with subject line  
"Sample Order\_ [Project Name] / [Specifier/Designer]"  
All samples are subject to Studio M approval and must show proof of project and/or explanation.

Job Name:	Job Type:
Quantity:	Comments